

CHAPTER 17 OBJECTIVES

LESSON ONE



Preparing Yourself and Your Car for a Short Trip

1. Describe how you would prepare yourself and your car for a short trip and the reasons for doing so.

LESSON TWO



Getting Ready for a Long Trip

2. Explain how you would get ready for a long trip and how you would prepare yourself and your car, as well as budget your money and plan your time.

LESSON THREE



Loading and Driving with a Trailer

3. Describe factors you should be aware of when planning to use a trailer.
4. Explain the procedures for driving a car with a trailer attached.

LESSON FOUR



Driving Safely in a Recreational Vehicle

5. Explain the importance of visibility and vehicle size when driving a recreational vehicle, and describe how you can protect yourself and other motorists.

Most traffic fatalities happen within 25 miles, or a short trip's distance, of the driver's home. Have you thought about ways to reduce your chances of being in a collision when you take a short trip away from home?

What Steps Should You Take When Planning a Short Trip?

A short trip can be a 5-mile drive to a neighborhood shopping center, a 2-mile drive to work or school, or a 45-mile trip to visit a relative who lives in another town. Even if you make the same trip every day, being prepared can help you reduce the risk of being in a collision.

Use a map to make sure you know how to get where you're going.

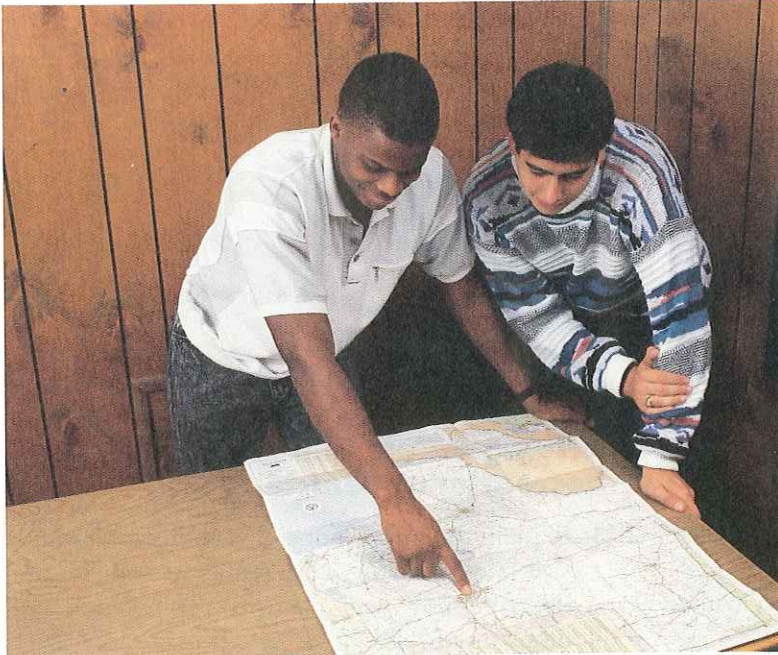

Prepare Yourself

You need to make advance preparations for a trip even if you'll only be driving a short distance. Ask yourself these questions before you get into the car.

Do I know how to get where I'm going? If you are going someplace you have never been before, work out your route in advance. Make sure that you have specific directions to follow, and use a map to check them out. Know the names of the streets and roads that you have to follow. Make sure that you are able to drive on them in the direction you want to go.

Do I know another way to get there? Sometimes even the best plans just don't work out. Your planned route may be blocked for many reasons, so it's smart to have alternative plans to get where you're going by another route.

Do I have everything I need? Even though you will probably not take any luggage on a short trip, you may need some or all of the following items: identification; money; addresses; directions or a map; and a list of things to do, see, or buy.

Have I given myself enough time? Hurrying can make you nervous and careless. First figure out how long the trip should take, then add some time for the unexpected. You can anticipate some delays by listening to the radio for weather conditions and traffic reports.

Tips for New Drivers

Working a Self-Service Gas Pump

To operate a self-service gas pump, pull up to the pump that dispenses the kind of fuel your vehicle uses. If a sign says "Pay Cashier Before Pumping," the pumps will not operate until you pay. Otherwise, pump the amount you need, and pay when you are done.

1. Open the fuel filler door and take off the gas cap.
2. Take the pump nozzle off its cradle and place the nozzle in the fuel tank opening.
3. Turn on the pump switch. It is usually located near the pump nozzle cradle.
4. Squeeze the lever on the pump nozzle to begin pumping the fuel.
5. If you have prepaid, the pump will shut off automatically. If not, shut the nozzle off and put it back on its cradle. Turn off the pump switch. Then put the gas cap back on and shut the fuel filler door.

Am I going at a good time? Try to avoid rush-hour traffic. There's no reason to get involved in a traffic jam if you don't absolutely have to. As you plan your route, remember that roads leading into urban areas will be busiest during the morning rush hours and roads leading out will be busiest in the evening rush hours.

Prepare Your Car

Every time you use your car, you should check to be sure that it is in proper condition to be driven. (See Chapter 6 for predriving checks.) You should check that:

- ◆ tires are properly inflated
- ◆ signal lights are working
- ◆ front and back lights are in order
- ◆ you have enough fuel and oil

Preparing yourself and your car for a trip does not take a lot of time. However, the time you spend in prep-

aration will save you time and trouble in the long run.

CHECKPOINT

1. What are some helpful questions to ask yourself as you prepare for a short trip?



WHAT WOULD YOU DO?

You had last-minute errands and are going to be late for an appointment. What would you do next time to avoid this situation?

You face risk when you take a long trip, just as you do when you take a short trip. Fatigue, unfamiliarity with the area, and uncertain weather conditions are some factors that can increase driving risk on a long trip. Long trips also present you and your car with some different needs.

What Should You Do to Prepare for a Long Trip?

If you plan to take a long trip, some of the preparations you should make are similar to those you make for a short trip. Others, however, are important only when you are traveling long distances.

Prepare Yourself

Here are some questions that you should ask yourself to prepare for a long trip.

◆ **How will I get where I want to go?** You may choose the most direct route to your destination, or you may choose to drive on a more leisurely route through scenic country. Whichever you choose, plan your route carefully. Use a map and keep in mind the risks that each route may pose. The most direct route may involve expressway driving, where high speeds and large trucks present special problems. On the other hand, a scenic route may lead through congested towns or wilderness areas with no gas stations or places to stay.



Although a scenic route may be more enjoyable, a limited-access highway tends to be much safer and more energy efficient. You'll have fewer stops, starts, curves, and hills, and you'll be able to maintain a steady speed for longer periods of time.

Call ahead to make reservations at hotels or motels along your route and at your destination.

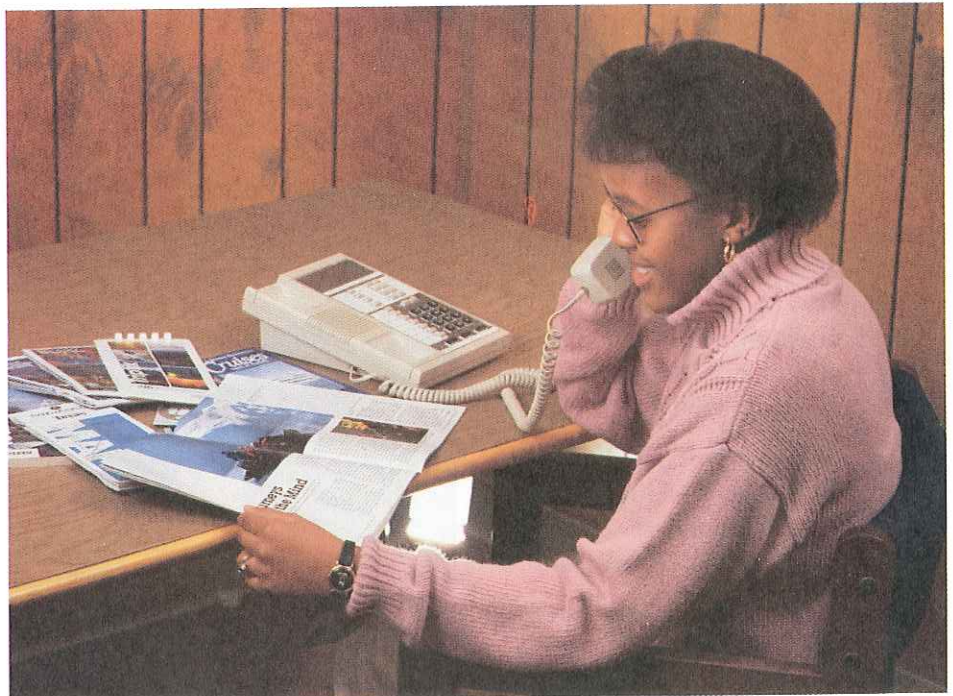

BUDGET						
	Food	Lodging	Gas	Tolls	Parking	Recreation
Day 1	\$75	\$95	\$18	\$5	—	\$20
Day 2	\$120	\$70	\$15	—	\$5	—
Day 3	\$70	\$80	\$15	\$3	—	\$15

SCHEDULE					
	Depart Place	Time	Average Speed	Arrive Place	Time
Day 1	Holyoke	7:00 A.M.	40 mph	Boston	9:00 A.M.
Day 2	Boston	2:00 P.M.	45 mph	NYC	6:00 P.M.
Day 3	NYC	6:00 A.M.	45 mph	Washington, D.C.	11:00 A.M.

Plan your route before you start the trip. Don't try to read a map while you're moving on the roadway. If you need to check the map, pull into a rest area or onto the shoulder when it is safe to do so.

You may want to write to or visit an auto club or travel agency to obtain maps, route suggestions, and recommendations on places to stay.

◆ **Where will I spend the night while I am on the road?** Plan where you will spend each night, and make your reservations in advance. Ask about rates and parking facilities, and figure this information into your budget and schedule.

◆ **Have I had enough sleep the night before driving?** Be sure that you get enough rest before getting

behind the wheel. If you become tired while driving, pull over at a rest stop.

A good plan is to drive in two-hour stretches with 15-minute breaks in between. Don't try to drive more than a total of eight hours in a day. If you're traveling with a partner who also drives, share the driving task.

Budgeting Money and Planning Your Time

A long trip can be expensive. To figure out how much money you'll need, make a budget. Use the categories above, adding others if you need to. Figure your budget by the day or by the week. Your emergency supplies should include an extra set of



On most cars, the recommended tire pressures are located on either the right- or left-center posts. However, never exceed the maximum tire pressure stamped on the sidewalls of the tires themselves.

BEFORE THE TRIP CHECKLIST

Emergency Supplies	Professional Car Checkup	Maps and Travel Books
extra fuses	brakes	city maps
gloves	transmission	state maps
duct tape	shocks	places of interest
flashlight		
first-aid kit		
keys		



WHAT WOULD YOU DO?

You and your family are about to take a three-week driving trip. What would you do to make this car trip-worthy?

car keys as well as replacements for or additions to supplies you normally carry in your trunk. (See Chapter 14 for a list of emergency supplies.)

Planning your travel time by making a schedule is also helpful. In making up your schedule, consider such factors as rush-hour traffic, speed limits, the kind of route you want to take, how far you want to drive at a time, and occasional stops for stretching, eating, and relaxing. Plan your driving time so that you avoid morning and early-evening rush-hour traffic.



Prepare Your Car

Your car should always be in good condition. However, before a long trip, you should have a mechanic check the following:

- ◆ brake shoes and pads
- ◆ exhaust-system leaks
- ◆ front-end alignment
- ◆ tire condition
- ◆ fluid levels in the engine, transmission, and battery
- ◆ shock absorbers
- ◆ belts and hoses

Pack the car carefully. Overloading can have an adverse effect on your car's handling, acceleration, and fuel efficiency.

Before you load your car, consult your owner's manual for the maximum weight load recommended per tire. Then be sure that your tires are inflated to the tire pressure recommended to carry any extra weight.

When you pack the car, follow these additional guidelines.

- ◆ The heaviest objects should be packed at the bottom of the trunk.
- ◆ If you use a car-top carrier, be sure to place only lighter objects in it.
- ◆ Do not put anything on the rear-window shelf that will obstruct your view of the roadway behind you or that can be thrown forward in a sudden stop. Do not hang clothing over the back-seat windows.

CHECKPOINT

2. How can making a budget and schedule help you plan a long trip? How can you prepare yourself and your car for a long trip?

Many drivers tow boats, campers, or other kinds of trailers behind their cars. Towing a trailer, however, can make the driving task more difficult.

What Do You Need to Know About Trailers?

Knowing some of the special features and needs of trailers can help you to minimize the risk when driving with one attached to your car.

Weight of the Trailer and Its Load

Many vehicles are limited in the amount of weight they can pull in a trailer. Carefully consider the weight of your car, the weight of the trailer you're planning to haul, and the weight of the load. Be sure your car is

equipped to haul and control the loaded trailer. Check your owner's manual to see that you will not exceed the recommended factory load limits.

Necessary Equipment

If you intend to haul a trailer frequently, your car may need additional equipment, such as a heavy-duty suspension, a large-capacity radiator, and heavy-duty shock absorbers. For any size trailer, you will need to add mirrors on the car to increase visibility. You also need extra emergency equipment for heavier trailers. Extra equipment includes a hydraulic jack, blocks for holding on grades, and tow ropes.

To tow a trailer, the car needs a hitch and safety chains. For ordinary loads, use a hitch that is welded



The poorest trailer hitch is a bumper attachment unit. Do not use this kind of hitch for anything except the very lightest loads. Also note that it is extremely dangerous to try to attach a bumper hitch to nearly all new cars.



The most common use of a trailer is to tow a boat.



▲ *Be sure to use safety chains when you hitch a trailer to your car.*

or bolted to the frame of the car. You can buy such a hitch from auto supply outlets or through a car dealership. For heavier loads, there are special hitches for load equalizing. When your hitch is installed, make sure that also installed is an electrical outlet for the trailer's tail-lights, stoplights, and turn signals. More information about installing hitches can be found in the trailer's manual.

Preparing Your Car to Tow a Trailer

The increased load that a trailer puts on your car means that you will need to check your oil and transmission fluid more often than usual. You will also need to replace air, oil, and fuel filters sooner than you ordinarily would. In addition, you may need to increase the air pressure in your tires.

Packing a Trailer

The rear end of your car will have to support 10 to 15 percent of the trailer load. Therefore, the car itself should carry 10 to 15 percent less than the maximum weight recommended by the owner's manual. Too much weight in the back of the car will cause its front to rise and will affect steering, braking, and the aim of the headlights.

When you pack the trailer, follow manufacturer's guidelines. Load the heaviest items at the bottom, over the trailer wheels. About 60 percent of the weight should be packed in the front half of the trailer, and the total weight should be about equal from

THE **SOCIAL** **STUDIES** **CONNECTION**

To drive in many foreign countries, all you need is your valid driver's license and a tourist visa for the country you'll be visiting. However, an international driving permit is accepted nearly everywhere. An international driving permit is especially useful if you do not speak the language of the country you'll be driving in.

You can request an application for an international driving permit from your local American Automobile Association (AAA) in writing, or go there in person. The AAA is the only authorized organization in the United States that can issue such a permit.

To obtain an international driving permit, you need to fill out an application form, have a passport-size photograph taken, pay the appropriate fee, and show proof that you have a valid driver's license from your state.



side to side. Be sure to pack all items tightly or tie them so that they cannot shift during driving maneuvers.

After you have loaded the trailer, check what you have done. The bottoms of both the car and the trailer should be nearly parallel to the ground. The back springs of the car should not be extended so that its front end rises. On the road stop frequently at rest stops to make sure that the load and the hitch are still secure.

How Do You Drive a Car with a Trailer Attached?

No matter how skillful you are behind the wheel of a car, towing a trailer requires new driving skills and plenty of practice.

Starting

Your car's maneuverability and acceleration are limited when you're towing a trailer. Check traffic carefully and signal before moving. Allow

a very large gap before entering traffic. Start slowly, and check other traffic movement in the rearview and side mirrors frequently.

Backing

Backing is a difficult maneuver when you're towing a trailer. Before you begin, get out of your car and check behind the trailer to be sure that the way is clear. Try to have someone guide you from outside the car.

◀ Pack a trailer so that 60 percent of the load is in the front half.

SAFETY TIPS

If you are pulling a trailer, you will need twice the distance to merge into traffic, to pass another vehicle, or to stop.

Practice backing with a trailer before you actually need to do it.

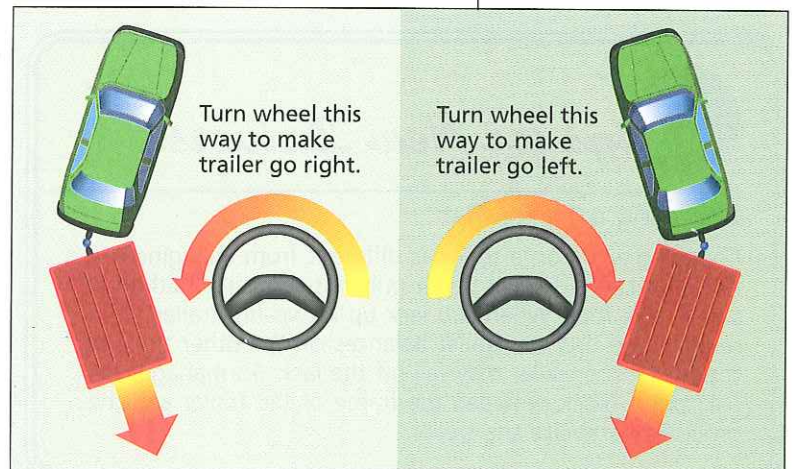



The wheel may be civilization's most important technological development. The wheel is believed to have been invented in about 3500 B.C. Its invention is credited to the Sumerians, a civilization that developed in the Tigris-Euphrates Valley in what is now known as Iraq.

It is easier to turn while backing up if the trailer turns to the left side of your car. This way, you can see the trailer over your left shoulder.

Follow these guidelines to back with a trailer.

- ◆ Back slowly.
- ◆ To go left, turn the steering wheel to the *right* and then straighten it.
- ◆ To go right, turn the steering wheel to the *left* and then straighten the wheel.
- ◆ Don't turn the steering wheel too much or hold it in the turned position too long. Doing so can cause the trailer to jackknife.

Making a Right Turn

As you approach an intersection where you want to turn right, follow these steps.

1. Check traffic and signal for the right turn in advance of the intersection.
2. Take a position farther from the curb than you would if you didn't have a trailer attached.
3. Steer the car straight ahead until the front wheels are well beyond the curb line.

Tips for New Drivers

Changing a Trailer Flat

Changing a tire on a trailer is different from changing a tire on a car. A typical trailer only has two tires, although some have four. When you jack up a two-tire trailer to remove one tire, the trailer balances on the other tire and the hitch. The trailer may fall off the jack. To manage this risk, put a block between the frame of the trailer and the ground to stabilize the trailer.

4. Turn the steering wheel sharply right.
5. Complete the turn by straightening the steering wheel.

Making a Left Turn

To turn left, follow these steps.

1. Check traffic and signal early.
2. Proceed farther into the intersection than usual, to allow for the trailer.
3. Swing wide enough so that the trailer will not cut the corner.
4. Complete the turn and move into traffic.

Overtaking and Passing

When you plan to overtake and pass another vehicle, allow much more time and space because of the length and weight of the trailer.

1. Be sure that there is plenty of clear distance ahead.
2. Check blind spots to the left and right before starting.
3. After passing, be sure you can see the overtaken vehicle in the rear-view or side-view mirrors before signaling and moving gradually back into the right lane.

Don't swerve suddenly. Doing so may cause the trailer to tilt, sway, or even go out of control.

Being Overtaken

When you are being passed by a light vehicle, observe the same rules that you do in a car. (See Chapter 8.) However, if a heavy vehicle is passing you, the air that it displaces will tend to push the trailer to the side. Be ready to adjust your steering. If you notice traffic piling up behind you,

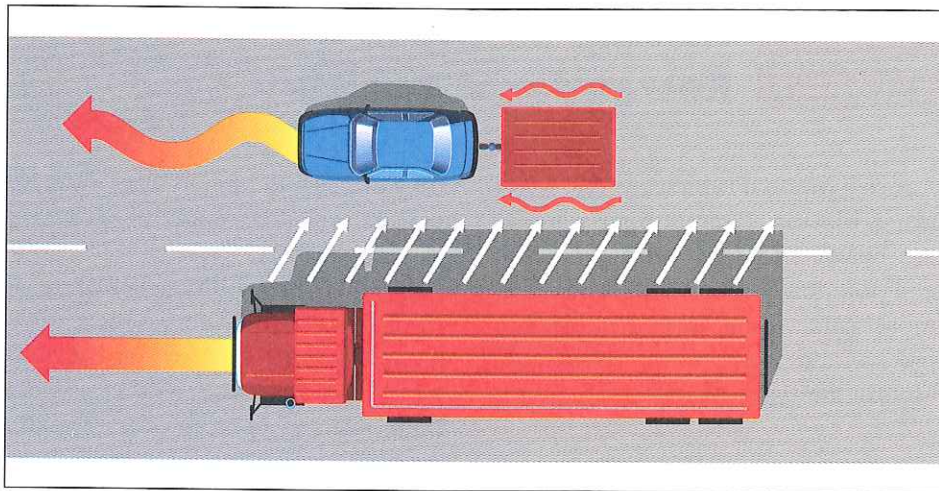

The draft from large vehicles can make a trailer move from side to side. Be ready to adjust steering.

try to find a place to stop and pull off the roadway. Be courteous and help other drivers to pass you.

Slowing and Stopping

If your trailer does not have brakes, the brakes on your car control all slowing and stopping. If the trailer does have brakes, then your car's brakes control the trailer's brakes. Be sure to practice braking before entering traffic.

The additional weight and length of the trailer means that you will need more time and space to stop. When you do enter traffic, allow a greater following distance than you ordinarily would.

If you have never driven with a trailer before, practice in an empty lot or on a lightly traveled roadway until you are sure you have the skills necessary to handle the extra load. Don't just get in your car and start driving on a high-speed roadway!

Before driving with a trailer, check your insurance to be sure that you are covered for towing a trailer. Also check the laws about trailers in states that you will be traveling through. Be

aware that in some states, passengers may not ride in a trailer while it is in motion. If you will be driving with passengers in the trailer, have safety belts or harnesses installed, and be sure your passengers use them.

CHECKPOINT

3. Why is it important to pack a trailer carefully?
4. Describe some of the ways in which driving with a trailer is different from driving without one.



WHAT WOULD YOU DO?

You want to make a left turn. What would you do?



A recreational vehicle, or RV, is not just a big toy. Recreational vehicles are heavier, longer, more powerful, and potentially more dangerous than most cars. Vans, caps on pickup trucks, and large motor homes are among the types of RVs.

they are sitting higher. This gives RV drivers an advantage in planning driving strategy.

Although the ability to see ahead is improved when driving a recreational vehicle, visibility to the rear can be a problem because RVs are wider than ordinary cars. To overcome this problem, adjust the large mirrors on the sides of the vehicle to be sure that you have maximum visibility in all directions.

SAFETY TIPS

If you're driving an RV or have a trailer attached to your car, keep to the right on a left curve, in order to keep the vehicle from crossing the center line. Reduce speed for better vehicle control.

How Do You Drive Recreational Vehicles?

Before you drive any recreational vehicle, you need to know its special features and requirements.

Vehicle Size

Recreational vehicles are wider and higher than cars. This greater width and height, and the greater weight of RVs, pose special problems that you must learn to deal with in order to manage risk.

Visibility

Drivers of RVs can see farther ahead than drivers of cars because

Because you sit higher in an RV, you can see farther ahead than you do in a car.





◀ Look for signs on underpasses that tell you what the maximum clearance is.

Be alert for wind. Recreational vehicles tend to sway in heavy winds because of their greater height and their higher center of gravity. Slow down or stop, if possible, if the wind is strong and you are having trouble controlling the vehicle.

Know the height of your vehicle. Remember, you are driving a vehicle that is much higher than a car. Be alert to anything above the roadway, including tree branches and overhanging wires. Look for signs that indicate height restrictions for tunnels or underpasses. Do not attempt to maneuver the vehicle through a too low tunnel or underpass. Instead, if traffic is light and it is legal, make a turnabout. If you are traveling on an expressway, signal, and move well off the roadway. Wait for a police officer to assist you off the expressway.

Know the weight of the fully-

loaded vehicle. Many bridges are posted with signs that show the maximum allowable tonnage per vehicle. You increase risk enormously if you try to cross a bridge when your vehicle is over the weight limit.

Protecting Other Motorists

Adjust your driving to take into account that you are driving a larger and wider vehicle than most of the others on the road. Maintain a greater margin of space around the vehicle. Keep in mind that you may be blocking the visibility of other drivers. Take this into consideration when you spot potentially threatening conditions ahead that cars behind you may not see.

Increase your following distance to give yourself more time to maneuver and stop. Manage the risk to yourself



More than half of all deaths of passenger vehicle occupants occur on Friday, Saturday, and Sunday. Keep this in mind when planning recreational trips.



On roads curving to the right, steer farther from the edge of the pavement than usual. Otherwise the wheels of your RV or trailer may drop to the shoulder, causing a dangerous sway or tire damage.

Advice From the Experts

Bill Hughes, Director,
National Travel, AAA



Bill Hughes, Director

Allow sufficient time to get to your destination to avoid feeling rushed and making last minute decisions. Keep a sufficient amount of fuel in your vehicle—you may not know how long it is to the next service station. Plan your stops so that you don't find yourself in an area where suitable accommodations cannot be found. Select a map that offers the proper level of detail to ensure that you can find your way safely. Check the map for toll roads to make certain you have enough cash to get to your destination.



WHAT WOULD YOU DO?

Before pulling out, what would you do to check the vehicle?

and to others by staying alert and allowing extra time and space to accomplish driving maneuvers.

Protecting Yourself

Driving long distances is always strenuous and requires frequent rest stops and careful planning. Because

of a recreational vehicle's size and difficulty in maneuvering, you will get tired even more quickly than when you are driving a car. Manage risk to yourself and your passengers by planning to drive shorter distances and resting more often than you would if you were driving a car. If possible, share driving duties.

As with a trailer, check your insurance to be sure that you are covered for driving a recreational vehicle. Also check the laws about RVs in all of the states that you will be driving through. Install safety belts in the living quarters of the RV, and insist that passengers who ride there use the belts.

CHECKPOINT

5. How do the size and weight of a recreational vehicle make driving it more difficult than driving an ordinary car?



CHAPTER 17 REVIEW

KEY POINTS

LESSON ONE

1. To prepare yourself for a short trip, have good directions or a map, know an alternate route, take all the items you need, allow extra time, and avoid rush-hour traffic. To prepare your car, be sure that tires are properly inflated, signal lights are working, front and back lights are in order, and that you have enough gas and oil. You need to prepare for a short trip in order to reduce the risk of a collision.

LESSON TWO

2. Prepare yourself for a long trip by planning your route, making a budget and schedule, making reservations, and being sure you get enough rest.

Prepare your car by having it checked by a mechanic and making sure you have adequate emergency equipment. Pack the car carefully.

LESSON THREE

3. When planning to use a trailer, consider the weight of the trailer and its load, the weight of your car, and whether your car can haul and control the loaded trailer. Be sure you have the

ment. Check the engine and transmission more often than usual. Pack the trailer so that 60 percent of the load is in the front half and the heaviest items are on the bottom, making sure the load is secure. Do not load your car to its maximum capacity.

4. To start a car with a trailer attached, check traffic, signal, allow a very large gap when entering traffic, and start slowly. To back with a trailer, move slowly and turn the wheel left when going right and right when going left. To turn, signal early, position the car beyond the curb line, and turn the steering wheel so that the trailer does not cut the corner. Allow extra time and space to pass, to be passed, and to slow and stop.

LESSON FOUR

5. Although RV drivers can see farther ahead than car drivers, they must compensate for the RV's width by using larger mirrors. The size of the RV may cause problems in winds, under overpasses, and on bridges. Protect yourself by resting often, driving shorter distances, and making sure you have proper insurance. Protect other motorists by increasing your following distance and allowing an extra margin of space.

PROJECTS

1. Choose four neighboring states through which you might drive to take a trip. Find out what their laws are about trailers and recreational vehicles. Compare other state laws with the laws in your own state. Prepare a report on their differences and similarities.

2. Find out where your ancestors lived or where they entered this country. Plan a trip to that place. Plot out your route, and make a budget and schedule. Visit an auto club or travel agency for advice. Mark your route on a map for display and report on your travel plans.

CHAPTER 17 REVIEW

BUILDING MAP SKILLS

Reading City Maps

Driving in a new city is often very confusing. Sometimes, merely figuring out how to get in and out of a city is puzzling.

Most maps have insets that show major cities in larger scale. Below is an inset map of Wichita, Kansas.

Suppose you are coming into Wichita from the north, on Interstate 135. To get to the Court House, you would leave Route 96 at the interchange for Central Avenue. Then you would head west to the intersection of Central Avenue and

Broadway. To get from the Court House to Watson Park, you would drive about 3 miles south on Broadway.

Try It Yourself

1. Locate Wichita State University on the map. How would you get from there to Friends University?
2. Suppose you are at the airport. How would you drive to Planeview Park?
3. How would you get from the corner of 25th Street and Amidon Avenue to the Wichita Art Association?

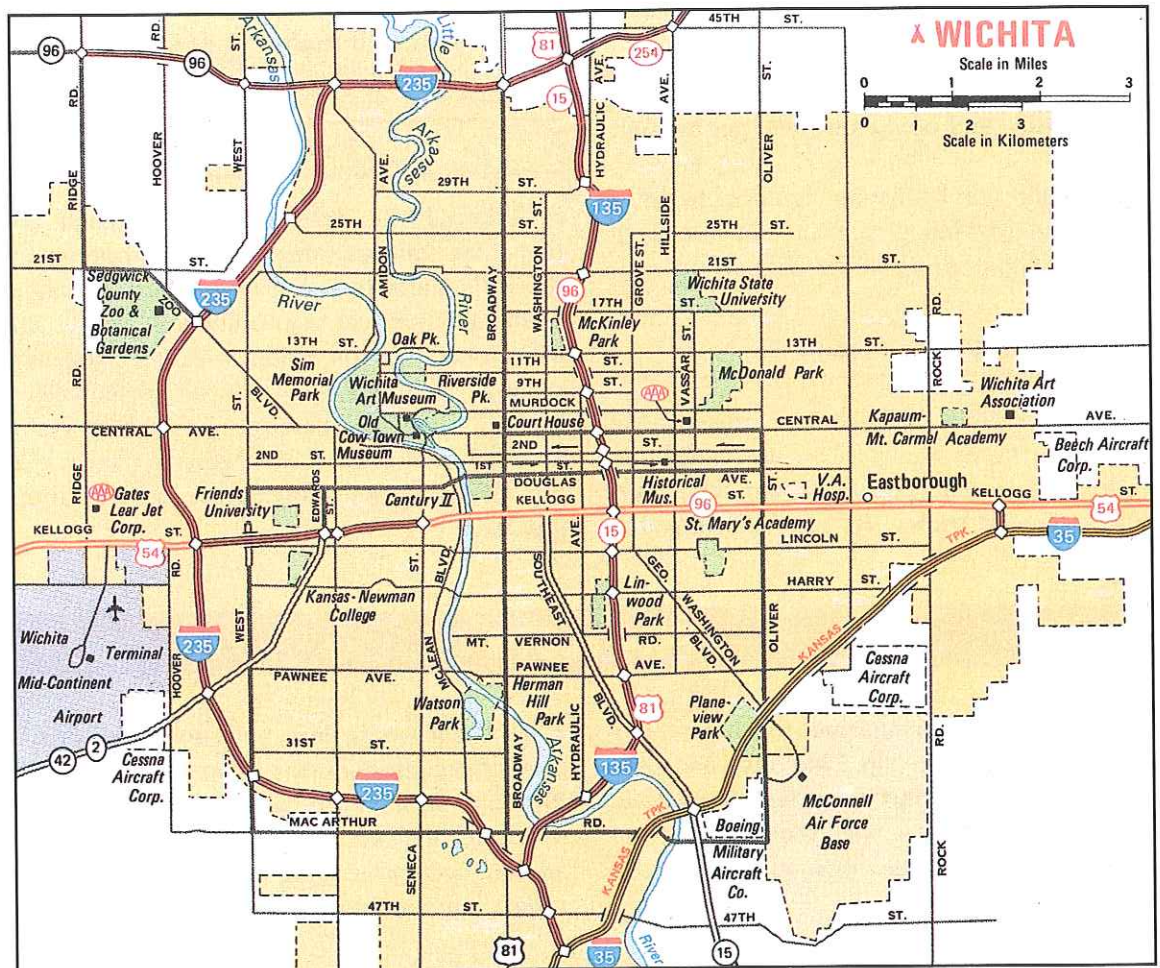

CHAPTER 17 REVIEW

CHAPTER TEST

Choose the letter of the answer that best completes each sentence.

- When packing a trailer, 60 percent of the load should be
 - over the wheels.
 - in the front half of the trailer.
 - at the bottom of the trailer.
- You should not drive more than a total of
 - eight hours a day.
 - five hours a day.
 - twelve hours a day.
- Most traffic fatalities occur
 - within 50 miles of the driver's home.
 - within 25 miles of the driver's home.
 - when a car is changing lanes.
- If you are going someplace you have never gone before, you should
 - use a road map while you are driving.
 - stop periodically to ask directions.
 - plan your route ahead of time.
- If you haul a trailer frequently, you may need
 - a hydraulic jack.
 - a car-top carrier.
 - a boat.
- You can anticipate some delays by
 - using a map.
 - having an alternate route.
 - listening to the radio for traffic and weather reports.
- Before starting on a long trip, you should
 - choose the quickest route.
 - choose the most leisurely route.
 - keep in mind the risks that each route may have.
- You can make a schedule to
 - know when to exceed the speed limit.
 - plan your travel time.
 - keep track of how much money you spend on a trip.
- When backing a trailer,
 - turn right to go left.
 - turn left to go left.
 - look over your right shoulder.
- Drivers of RVs can see farther ahead because they
 - are sitting higher than in a car.
 - have an advantage in planning driving strategy.
 - use extra large mirrors.

Write the word or phrase that best completes each sentence.

- overloading following distance
restrictions trailer hitch
shock absorbers urban areas
- Roads leading into _____ are busiest during the morning rush hour.
 - _____ can have an adverse effect on your car's acceleration.
 - Have a mechanic check for worn _____ before a long trip.
 - Use a _____ that is welded or bolted to the frame of your car.
 - When you drive an RV, you should increase your _____.

DRIVER'S LOG

In this chapter, you have learned how to plan long and short trips and how to safely drive recreational vehicles and tow trailers. Make a personal

checklist to remind you of considerations that you would take into account when planning a cross-country trip in a recreational vehicle.

DIVISION OF
MOTOR VEHICLES

Nebraska

UTAH
Driver Handbook

DRIVER'S
GUIDE

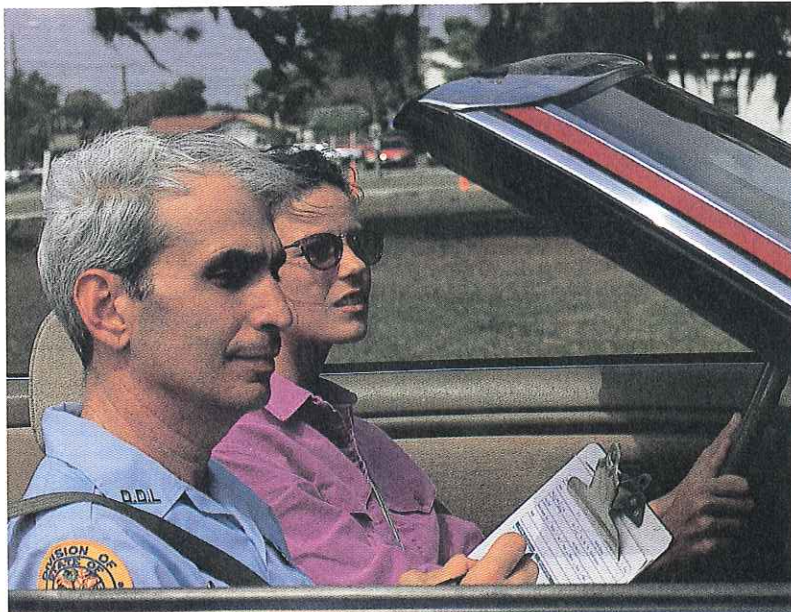

TUCKY
S MANU

CHAPTER ♦ 18

GETTING READY: YOUR STATE DRIVING TEST

You have learned a great deal about driving that will help you with your state's driving test. It is important that you know how to prepare yourself and your car for the test. Understanding how to prepare will help you to succeed.

Idaho
Driver
Manual